

# **OWNER'S MANUAL**

**(PLEASE READ BEFORE USE)**

**87163 IR Extender Kit Tx-Rx over Coax  
87163T Extension Tx IR over Coax for 87163**

## Important-Safety Precautions

- To prevent fire or shock hazard, do not expose this device to rain or moisture.
- To avoid electrical shock, do not open this product.
- This device should be operated to use only the power supply included with it or provided as all accessory.

### A. Checking Contents of Box

Check to make sure that all of the items shown as below are included with your 87163 system. If something is missing, please contact your dealer as soon as possible.

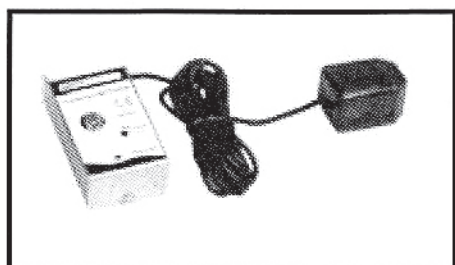

1. Transmitter  
87163T × 1

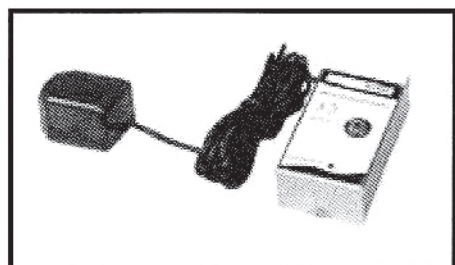

2. Receiver × 1

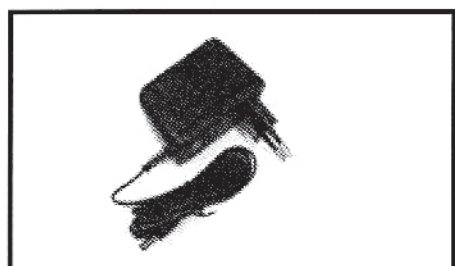

3. Power adapter  
100~240VAC to 9VDC × 2

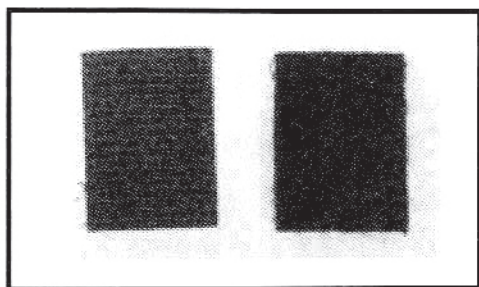

4.Fasten strips

×2

5.Owner's manual

×1

## B. Introduction to 87163

With **87163** Remote control Extension System you will be able to control (from any TV-SET of the house) any infrared equipment connected to another TV-SET (Digital or analog Satellite Receivers, VCR, CATV, HIFI, etc).

## C. Panel Controls and Features of Universal Type

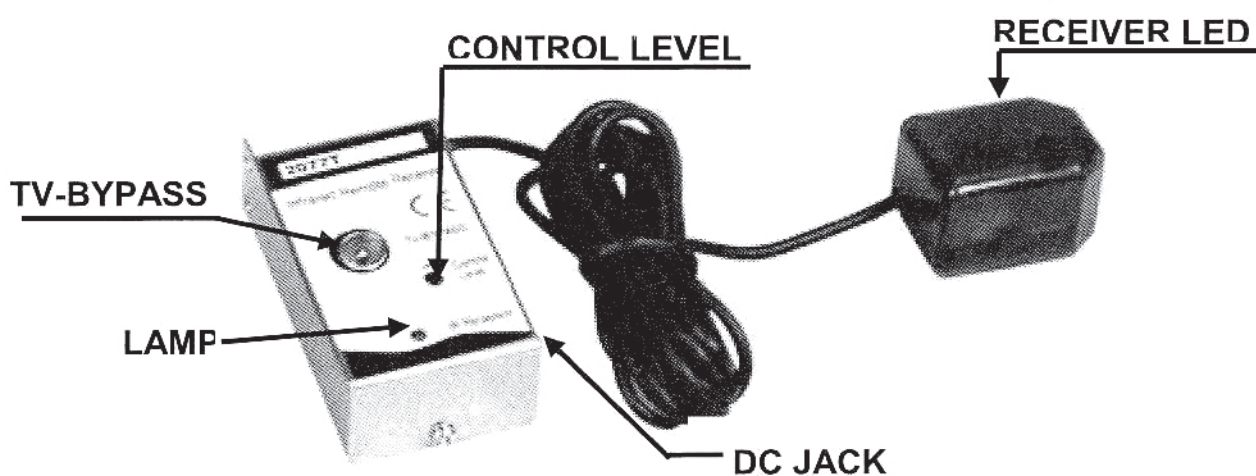

87163T

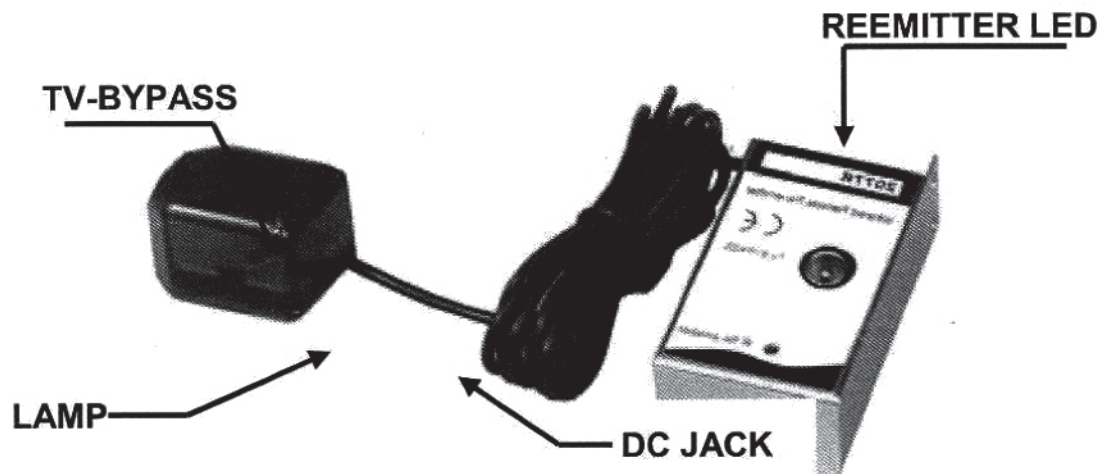

Receiver

## D. Setting up 87163

- For the correct location of the reemitter led over the equipment to be controlled (fig1-A), it is convenient to interconnect reemitter and receiver according to fig1-D, locating the receiver led «B» in a box in front of the remote controls. Before connecting **87163** power supplies to 230V, make sure that (from inside the box) the controls don't operate the equipment «E»

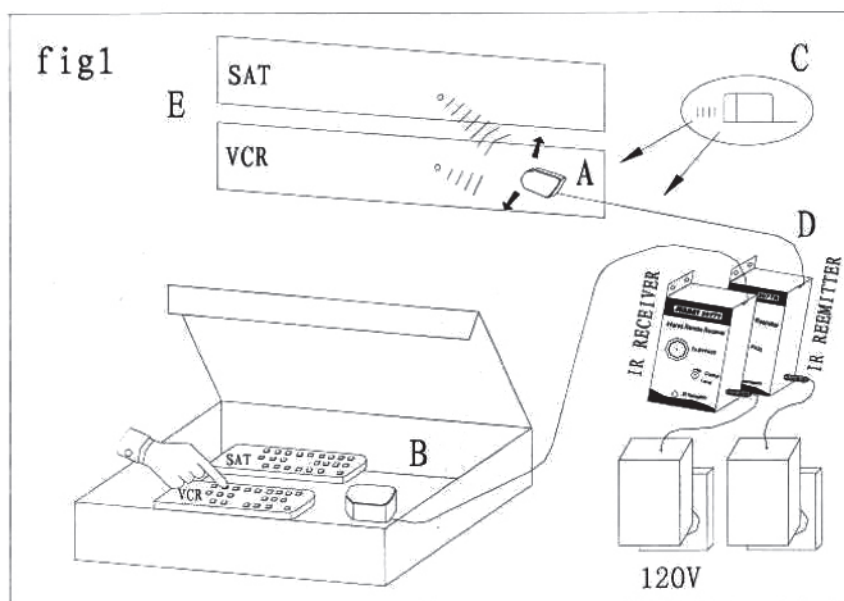

- You can now plug the power supplies and optimize the position of the reemitter Led «A» over the equipment «E» (operating remote controls at the same time).  
Keep in mind that the infrared leds emit and receive by the opposed part to the entrance of cable (see fig1-c).
- Make the assembly of the fig2 locating the REEMITTER on the TV-socket next to the equipments to be controlled (room1) and the RECEIVER on the TV-socket of the remote TV-set (room2). Receiver led (B) doesn't receive directly the emissions of reemitter led(A) and Remote controls operate normally after connecting **87163** power supplies (see fig2-c). Optimize now the situation of the B Led (fig2) for a correct Operation of the remote controls «D» on the equipment to be controlled «E» .

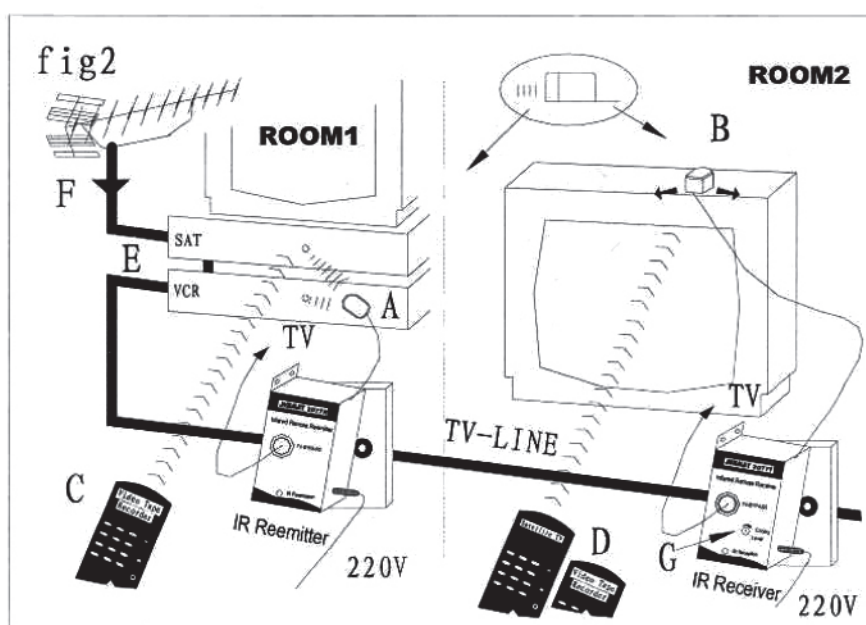

Note: It is convenient to begin this operation with the receiver level to maximum (fig2-G), minimizing later to an operative level without saturations and interferences.

In order to receive the equipment signal from all the TV-sets, you must have the equipment connected to the head of the installation as in fig2-E or in figs 3A, 3B or 3C. We recommend you the use of DIGI-SENDER/AV SENDER fig3C so as to carry out the function.

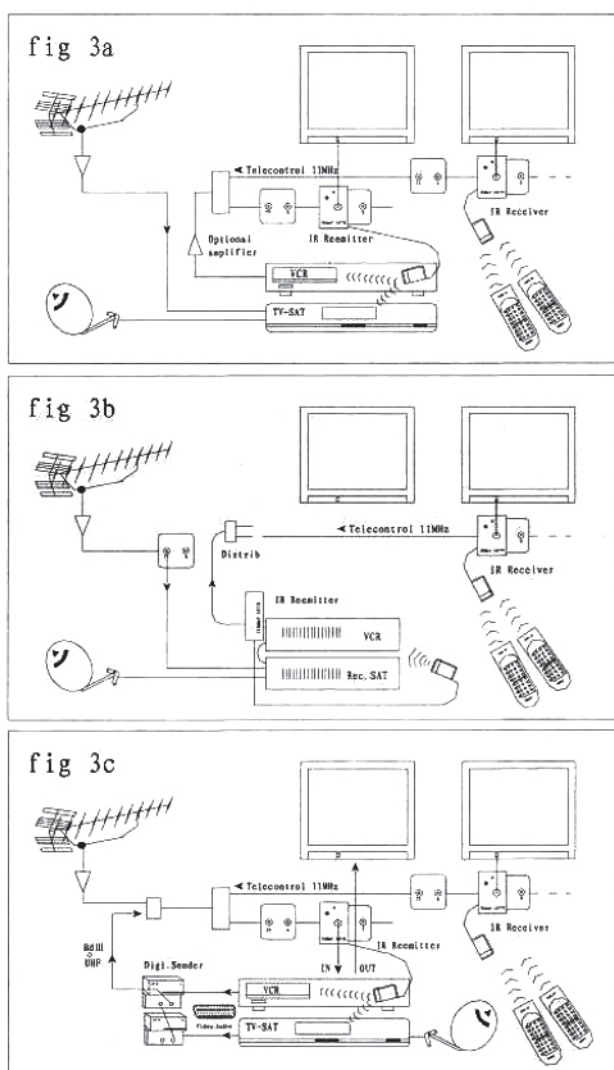

## E. Cautions

- Be careful that receiver and reemitter leds are correctly pointed without intermediate obstacles (see fig1-A and fig2-B).

- Although you can use any number of receivers and reemitter everywhere, be careful that the walls or domestic objects always stop the optical coupling between them. So avoid that the same remote control can operate simultaneously with two receivers (fig4a), that any reemitter can operate with any receiver (fig4b) or that two reemitters can operate at the same time with the same equipment (fig4c).

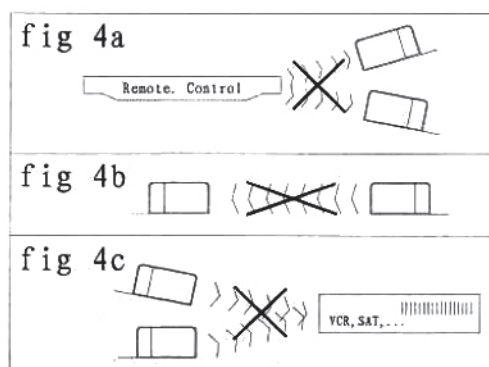

- At any point of the installation there is not an amplifier.
- In case of doubt or persistence of any problem consult your distributor.

## F. Specifications

### ● SPECIFICATIONS TRANSMITTER:

VHF/UHF-Attenuation: 0.5dB

Control signal:

Infrared freq input: 35~41kHz

Modulation level: 0dBm(0~10dB adj.)

Size: 70×38×23.5(mm)

Weight: 120g

### ● SPECIFICATIONS RECEIVER:

VHF/UHF-Attenuation: 0.5dB

Control signal:

Input: 11MHz-ASK

Minimum level: <50dB  $\mu$  V

Infrared output :  $37 \pm 1$ kHz

Size: 70×38×23.5(mm)

Weight: 130g

## Trouble shooting care and maintenance

If you have some difficulties, consult the following table.

It will guide you through the most common problems and their solutions.

Problem	Possible Solutions
Reemitter Led does not work	<ul style="list-style-type: none"><li>● Check power supplies</li><li>● Adjust controlling Level</li></ul>
No picture and sound	<ul style="list-style-type: none"><li>● Check TV Bypass connections</li><li>● Check power supplies</li></ul>
Remote controls do not work	<ul style="list-style-type: none"><li>● Be careful that receiver and reemitter leds are correctly pointed without intermediate obstacles.</li><li>● At any point of the installation there are some amplifiers.</li></ul>

The logo for 'emme esse' is displayed in a white, stylized, cursive font. It is centered within a solid red rectangular background.

**emme esse**